

EXISTING AREAS – 1965 NORTHERN CALIFORNIA
WITH OPEN SPACE PROPOSALS

URBAN METROPOLITAN OPEN SPACE STUDY
CALIFORNIA STATE DEVELOPMENT PLAN PROGRAM

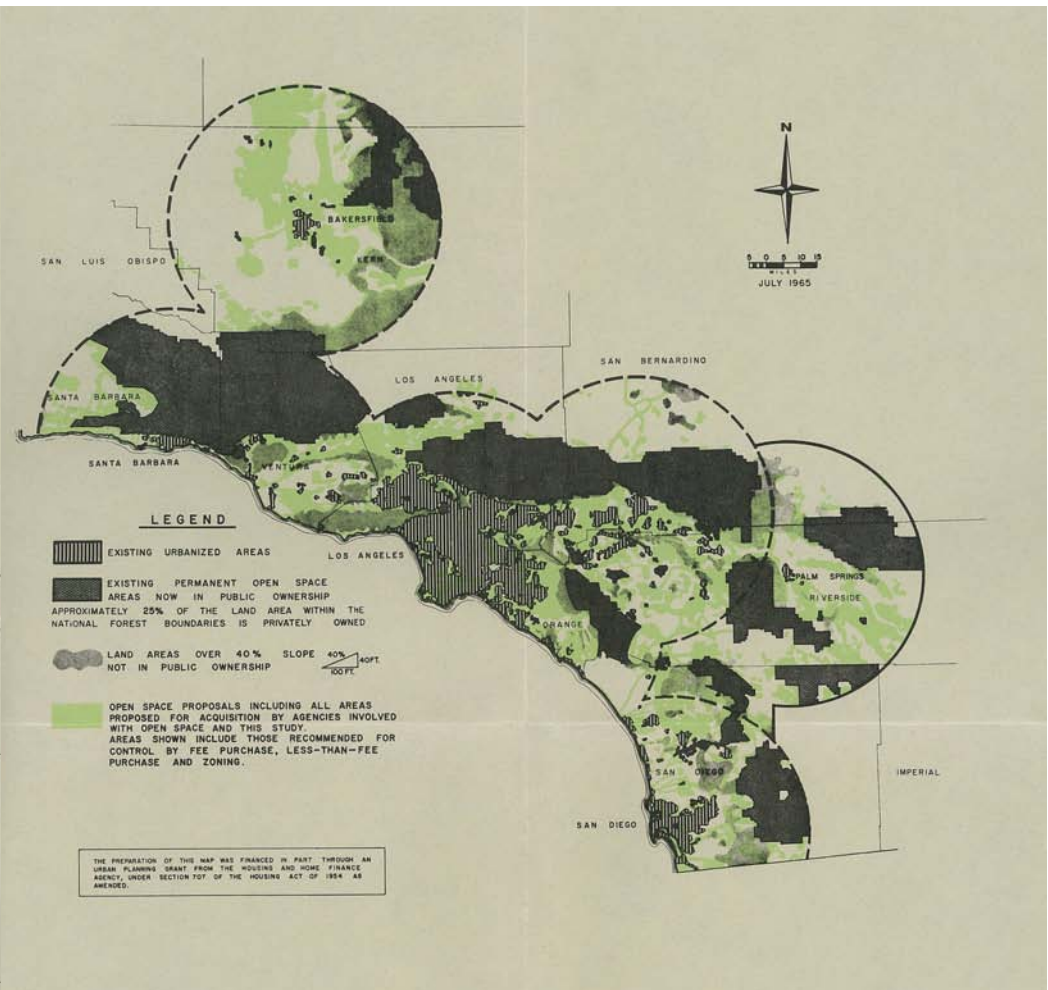

EXISTING AREAS – 1965 SOUTHERN CALIFORNIA
WITH OPEN SPACE PROPOSALS

URBAN METROPOLITAN OPEN SPACE STUDY
CALIFORNIA STATE DEVELOPMENT PLAN PROGRAM

1962-65

PROJECT
California Urban Metropolitan Open Space Plan

CLIENT
State of California

In a period in history when suburban sprawl was ascendant, EDAW's open space plan for the state of California was as innovative as it was provocative. The very idea of an 'open space plan' was a novel one. The firm drew up plans to preserve open spaces in danger of encroachment on the fringes of the greater Los Angeles-San Diego, Palm Springs, San Francisco Bay and Lake Tahoe areas. In addition to protected county, state and federal lands existing at the time, EDAW's plan identified a further 330,000 acres for protection. In strong language, it warned against the automobile and foretold the climate crisis. "A new ethical attitude about land use is needed," intoned EDAW's report, "in order to protect the environment for everyone's benefit."



1965

PROJECT
Mauna Kea Beach Hotel, Hawai'i

CLIENT
Laurance S. Rockefeller

"A persuasive demonstration for modern landscape architecture, Mauna Kea Beach Resort is in a class by itself in terms of its very large scale [and] pioneering solutions," says Tom Martensen in his upcoming book *Landscape Modernism* (2009). The resort was the first to introduce the idea of a leisurely outside/inside landscape that in the time since has come to define resort design.

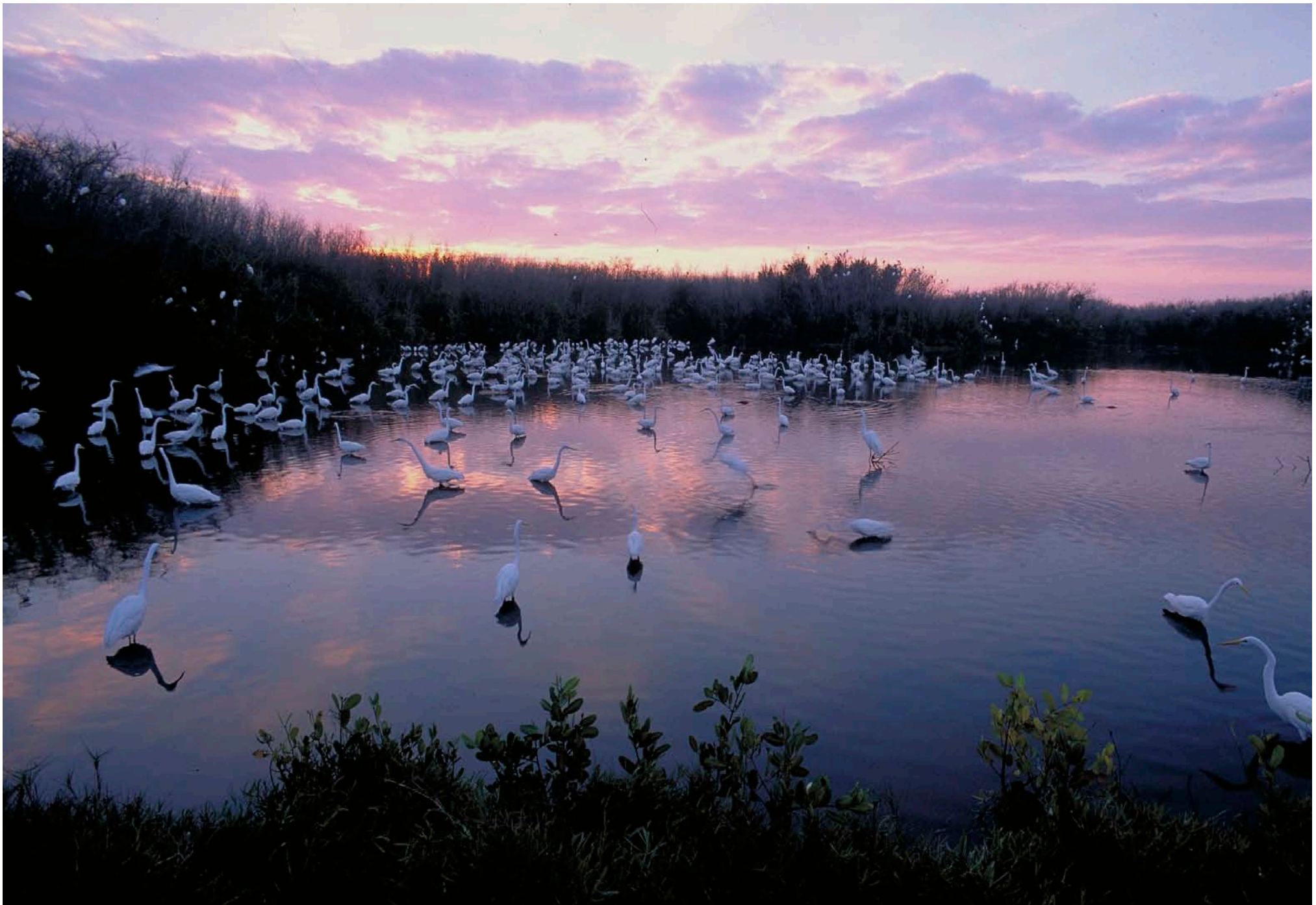

1991-2006

PROJECT

Protection of the Florida Everglades Ecosystem

CLIENT

U.S. Department of Justice

When the survival of Florida's Everglades were under threat by polluted water from a system of canals and levees managed by local authorities, EDAW was asked by the Federal Government to build a case for ecological restoration that according to *The New York Times*, "set in motion the most ambitious environmental initiative on the planet."



1993-2050

PROJECT
Monumental Core, Washington, DC

CLIENT
National Capital Planning Commission

Through many projects over the years, EDAW has helped to craft the landscape and cityscape of the national capital. The keystone of that work is the monumental core master-plan, which builds upon L'Enfant's original vision for the city to factor in the 155 memorials and 74 museums that have sprung up since his day. The framework will guide Washington's physical evolution through 2050, combining historic visions with anticipated realities.



1996

PROJECT
City Center, Manchester, UK

CLIENT
Manchester Millennium, Ltd.

An IRA bomb destroyed over 100,000m² of retail and office space in 1996 in the heart of this English city. EDAW's response, featured in the 2005 MoMA exhibit 'Groundswell,' included a development framework, a city center master plan, and public realm strategy to bring it back. Reflecting a characteristic commitment to this place, EDAW's involvement since has included the design of new public spaces (such as Piccadilly Gardens, pictured) and the opening of an EDAW studio in the city.



1996

PROJECT
Centennial Olympic Park, Atlanta

CLIENT
Georgia World Congress Center Authority

The focus and gathering place for Atlanta's 1996 Olympic Games, EDAW's design for Centennial Olympic Park looks beyond trees, promenades, water features and plazas to be a catalyst for urban regeneration and reinvestment in the inner urban core in the realm of \$2 billion. In a city that once lacked a central gathering space, today more than 1.5 million walk through the park per year.



2003

PROJECT
Jinji Lake, Suzhou, China

CLIENT
Suzhou Industrial Park Administrative Committee

Suzhou, home of legendary ancient gardens that are UNESCO-listed, has long relied on EDAW since the firm participated in a preservation workshop in the 1980s. As the city expanded around neighboring Jinji Lake, EDAW designed a collection of public open spaces around its 51.3km ring that is a fitting contemporary to the historic landscapes of the place Marco Polo equated with his home, Venice. EDAW's work was landscape architecture as social progress, commented *The New York Times* in a review in 2007.

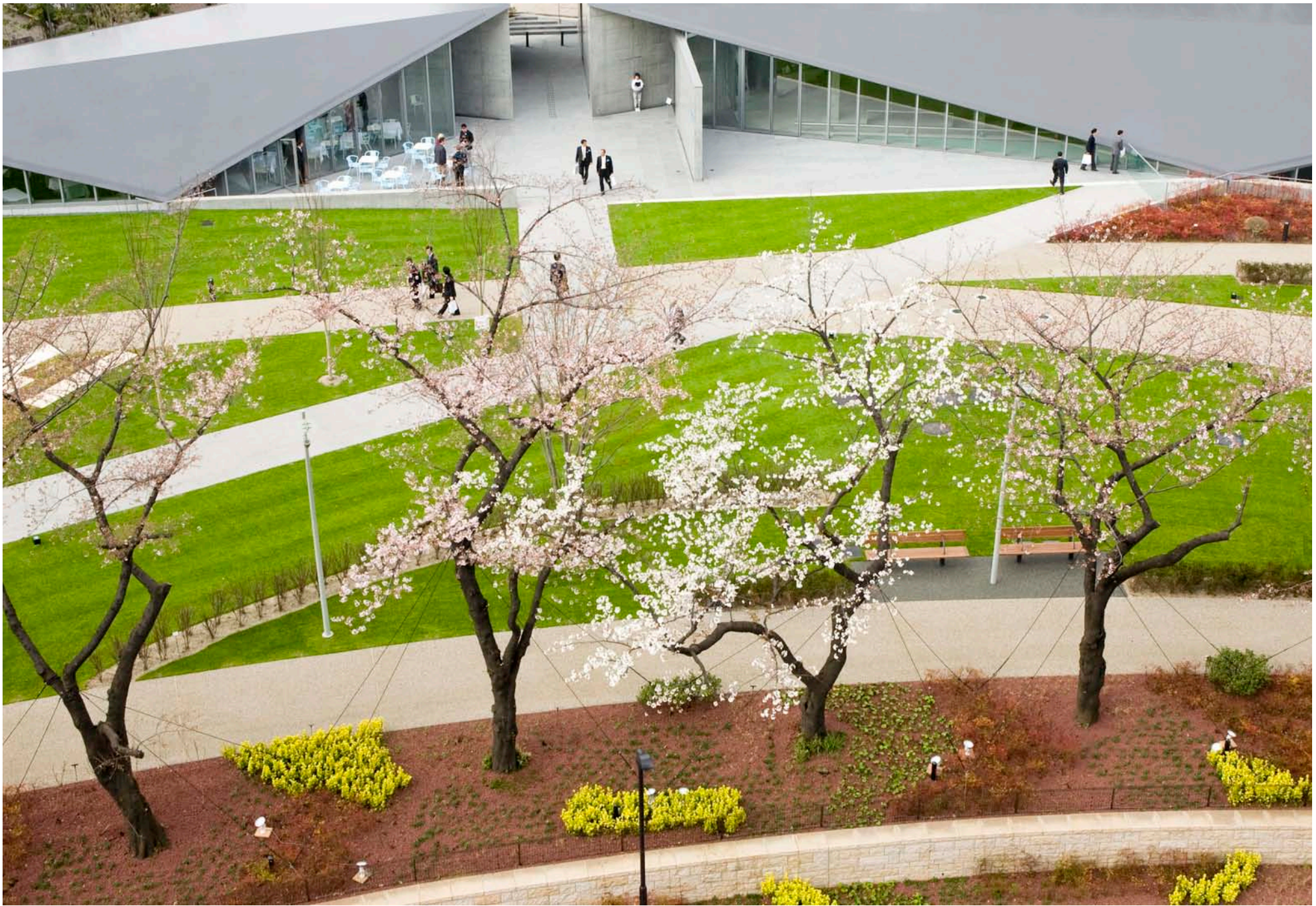

2007

PROJECT
Tokyo Midtown

CLIENT
Mitsui Fudosan, Ltd.

The Tokyo Midtown mixed-use development is the first of its kind that is led not by buildings, but instead by the landscape. In a city where land is incredibly expensive, more than half of the land area of what is Tokyo's most sought after development is dedicated to an open park designed by EDAW. Abstract and modern, vernacular yet cosmopolitan, EDAW's design offers a new value for public realm at the very heart of the world's largest city.



2008

PROJECT

San Pedro Waterfront, Los Angeles

CLIENT

Port of Los Angeles

For the people living in San Pedro, living on the Pacific Ocean has not been a lifetime at the beach because the waterfront has been dominated by an industrial landscape. EDAW's imprint on this lower income community is occurring through an ongoing collection of waterfront promenades and open spaces that are reuniting people with the water's edge. In the words of a local resident it is becoming a 'Grand Canal,' EDAW has designed "an educational spectacle, a great theatre; before, it was just a dead end."



2012

PROJECT

Lower Lea Valley Olympic Master Plan,
Olympic Park and Legacy Framework

CLIENT

London Development Agency

EDAW's master plan and legacy framework for the 2012 Olympic Games prioritizes the long-term regeneration of one of the UK's poorest areas. Under construction now, this project crystallizes EDAW's pursuit of elevating landscape architecture into a leadership role over how our communities and cities develop, and in a way that embraces social and environmental justice. Here, landscape architects are in the driver's seat, at the helm of a vast team of consultants, architects, and engineers on what will be Europe's most dramatic urban renaissance in nearly two centuries.

ASLA Achievements

Working ASLA Fellows

/ Howard Altman, FASLA
 / David Blau, FASLA
 / Joseph E. Brown, FASLA
 / Russell Butler, FASLA
 / Dennis Carmichael, FASLA
 / Craig Coronato, FASLA
 / Roger Courtenay, FASLA
 / Barbara Faga, FASLA

/ Herb Schaal, FASLA

/ Bill Vitek, FASLA

ASLA Medal Recipients

/ Garrett Eckbo, FASLA
Past ASLA Presidents
 / Dennis Carmichael, FASLA
 / Cheryl Barton, FASLA

Co-Chair, L.A.F. Campaign

/ Barbara Faga, FASLA

213

ASLA awards
since 1970

40

national awards
since 1970

10

working
ASLA Fellows

ASLA Awards since 1970

National Awards



Atlanta Beltline Redevelopment, 2007 National Honor Award, Analysis + Planning.



Denver Alpine and Rock Garden, 1983 National Merit Award.



Gateway Science School, 2000 National Merit Award, Design.



Red Butte Garden & Arboretum, 1999 National Design Award.



Signers' Memorial, Washington, DC, 1984 National Honor Award, Design.

- 2008 / Marley Park, Surprise, AZ, Merit Award, General Design Category, Arizona Chapter
- 2008 / WindMark Beach, Port St. Joe, FL, Award of Excellence, Resort & Entertainment Category, Florida Chapter
- 2008 / National Capital Framework Masterplan, Washington, DC Honor Award, Analysis/Planning, Potomac/Maryland Chapter
- 2008 / Norfolk Botanical Gardens, World of Wonder Children's Garden, VA, Honor Award, Design, Potomac/Maryland Chapter
- 2008 / Ford Orientation and Donald W. Reynolds Museum at Mount Vernon, VA Honor Award, Design, Potomac/Maryland Chapter
- 2008 / Wharf District Park, Boston, MA Honor Award, Design, Potomac/Maryland Chapter
- 2008 / North Shore Park, Pittsburgh, PA Merit Award, Design, Potomac/Maryland Chapter
- 2007 / Allegria Master Plan, Cairo, Egypt, Merit Award, Un-Built Works Category, New York Chapter
- 2007 / Atlanta BeltLine Redevelopment Plan, Atlanta GA, National Honor Award, Analysis + Planning Category**
- 2007 / Atlanta BeltLine Redevelopment Plan, Atlanta, GA, Merit Award, Planning + Analysis Category, Georgia Chapter
- 2007 / Atlanta BeltLine Redevelopment Plan Video, Honor Award, Communications Category, Georgia Chapter
- 2007 / Big Darby Accord, Franklin County, OH, Merit Award, Ohio Chapter
- 2007 / I-395 Urban Design Study, Miami, FL, Award of Merit, Analysis + Planning Category, Florida Chapter
- 2007 / Russell Forest at Lake Martin, Lake Martin, AL, Honor Award, Planning + Analysis Category, Georgia Chapter
- 2007 / Tuxedo Reserve Marbled Salamander Migration Study, Tuxedo, NY, Merit Award, LA Research Category, New Jersey Chapter
- 2007 / U.S. Patent & Trademark Office Headquarters, Alexandria, VA, Merit Award, Potomac/Maryland Chapter
- 2007 / Village in the Forest, Atlanta, GA, Award of Excellence, Communications Category, Georgia Chapter
- 2007 / WaterSound Beach Club, FL, Award of Excellence, Georgia Chapter
- 2007 / Woodland Park, Herndon, VA, Honor Award, Potomac/Maryland Chapter
- 2006 / Coastal Maine Botanical Gardens Master Plan, Boothbay, ME, Merit Award, Boston Chapter
- 2006 / Coastal Maine Botanical Gardens Master Plan, Boothbay, ME, President's Award of Excellence, Colorado Chapter
- 2006 / Harbor Boulevard Parkway, Los Angeles Waterfront, San Pedro, CA, Honor Award for Planning, Northern California Chapter
- 2006 / High Plains Arboretum, Cheyenne, WY, Merit Award, Colorado Chapter
- 2006 / Lena Meijer Children's Garden, Grand Rapids, MI, Honor Award, Michigan Chapter
- 2006 / Manchester: Rebuilding the City Centre DVD, Museum of Modern Art, New York, New York, National Honor Award, Communications Category**
- 2006 / Morton Arboretum Children's Garden, Lisle, IL, Honor Award, Colorado Chapter
- 2006 / South Fork Lodge, Swan Valley, ID, Honor Award, Colorado Chapter
- 2005 / Agua Fria Watercourse Master Plan, Maricopa County, AZ, Honor Award for Analysis and Planning, Arizona Chapter
- 2005 / Black Creek Sanctuary at Mountain Creek, Vernon Valley, NJ, Merit Award, New Jersey Chapter
- 2005 / Idlewild Park, Queens, NY, Merit Award, New York Chapter
- 2005 / Kierland Commons Town Center, Phoenix, AZ, Honor Award for General Design, and President's Award for Outstanding Project in Arizona, Arizona Chapter
- 2005 / Meredyth Place Medical Campus, Phase I, Albany, GA, Honor Award, Georgia Chapter
- 2005 / The Mohegan Sun Casino + Resort, Uncasville, CT, Honor Award, New Jersey Chapter
- 2005 / The Mohegan Sun Casino + Resort, Uncasville, CT, Honor Award, New York Chapter
- 2005 / Mount St. Helens Nat'l Volcanic Monument, Coldwater/Johnston Recreation Complex, Castle Rock, WA,**

National Honor Award, General Design
2005 / Newark Broad Street Streetscape Master Plan, Newark, NJ, Honor Award, New Jersey Chapter
2005 / Oakland Waterfront Bay Trail Alignment, Oakland, CA, Honor Award, Planning Category, Northern California Chapter
2005 / Parc Diagonal Mar, Barcelona Spain, National Honor Award, General Design Category
2005 / Port of Los Angeles Cruise Ship Promenade, San Pedro, CA, Honor Award, Design Category, Northern California Chapter
2005 / San Jacinto Battleground State Historic Site Cultural Landscape Report, Merit Award, Potomac/Maryland Chapter
2005 / Tuolumne River Regional Park Master Plan + EIR, Modesto, CA, Honor Award, Planning Category, Northern California Chapter
2005 / WaterSound Residential Community, Camp Creek, FL, Award of Excellence, Planning and Analysis Category, Florida Chapter
2004 / Brook Run Park + Recreational Facility Master Plan, Atlanta, GA, Honor Award, Georgia Chapter
2004 / 400MW Coal-Fired Power Plant Site Selection Study, IL, IA, MN, WI, Honor Award for Planning and Urban Design, Colorado Chapter
2004 / Georgia World Congress Center, West Plaza/Field of Dreams, Atlanta, GA, Merit Award, Georgia Chapter
2004 / Lena Meijer Children's Garden, Grand Rapids, MI, Merit Award for Design, Colorado Chapter
2004 / Mission Creek Park, San Francisco, CA, Merit Award, Northern California Chapter
2004 / Smithsonian Mall-Wide Perimeter Security Master Plan, Washington, DC Traveling Award, Potomac + Maryland Chapters
2004 / Stapleton Westerly Creek, Denver, CO, Land Stewardship Designation Award and, Merit Award for Design, Colorado Chapter
2004 / Theodore M. Berry International Friendship Park, Cincinnati, OH, Merit Award, Ohio Chapter
2004 / University of Kentucky Arboretum Children's Garden Master Plan, Lexington, KY, Merit Award for Planning and Urban Design, Colorado Chapter
2004 / Yampa River Management Plan, Steamboat Springs, CO, Land Stewardship Designation Award and President's Award of Excellence for Planning and Urban Design, Colorado Chapter
2003 / Children's Environmental Garden at Betty Ford Alpine Garden, Vail, CO, Honor Award, Design Category, Colorado Chapter
2003 / City of Greeley Conceptual Trails Plan, Greeley, CO, Honor Award, Planning and Urban Design Category, Colorado Chapter
2003 / Disney's Celebration Common Area Development, Celebration, FL, Merit Award, Maryland/Potomac Chapters
2003 / Ferry Farm (George Washington Boyhood Home) Master Plan, Stafford, VA, Honor Award, Maryland/Potomac Chapters
2003 / Jinji Lake Public Open Space, Park, Landscape Design – Cityside Harbor + Grand Promenade, Suzhou, China, National Merit Award, Design Category
2003 / Massey Hill Community Redevelopment Plan, Fayetteville, NC, Merit Award, Maryland/Potomac Chapters
2003 / Morton Arboretum Children's Garden Master Plan, Lisle, IL, Honor Award, Colorado Chapter
2003 / National Capital Memorials + Museums Master Plan, Washington, National Honor Award, Communications Category
2003 / Tidal Schuylkill River Master Plan, Philadelphia, PA, National Merit Award, Planning Category
2002 / 2002 Olympic Winter Games Cross Country/Biathlon Venue at Soldier Hollow, Wasatch Mountain State Park, Salt Lake City, UT, Honor Award, Design Category, Colorado Chapter
2002 / Centerra Design Guidelines, Loveland, CO, Honor Award, Planning + Urban Design Category, Colorado Chapter
2002 / City Center Livable Centers Initiative Master Plan, Atlanta, GA, Honor Award, Tri-State Chapter
2002 / Confluence Park Master Plan, Colorado Springs, CO, Merit Award, Planning + Urban Design Category, Colorado Chapter
2002 / Lena Meijer Children's Garden, Grand Rapids, MI, President's Award, Colorado Chapter
2002 / Longmont Downtown Enhancements, Longmont, CO, Merit Award, Design Category, Colorado Chapter
2002 / National Capital Memorials + Museums Master Plan, Washington, DC, Merit Award, Maryland and Potomac Chapters
2002 / Omaha Northeast Downtown Redevelopment, Omaha, NE, Merit Award, Design Category, Colorado Chapter
2002 / Stapleton Park Master Plan, Denver, CO, Honor Award, Planning + Urban Design Category, Colorado Chapter
2002 / West Florida Lands Strategic Plan, State of FL, Merit Award, Florida Chapter
2002 / Zellerbach Garden of Perennials, Strybing Arboretum, San Francisco, CA, Merit Award, Design Category, Colorado Chapter
2001 / California National Historic Trails Interpretive Center Siting Study, Land Stewardship Award and Honor Award for Planning + Urban Design, Colorado Chapter
2001 / Children's Garden at Red Butte Garden + Arboretum, Salt Lake City, UT, Honor Award, Colorado Chapter
2001 / EDAW Summer Student Program 2001, Denver, CO, Merit Award – Research + Communications, Colorado Chapter
2001 / Fort Collins Community Horticulture Center, Fort Collins, CO, President's Award of Excellence – Planning + Urban Design, Colorado Chapter
2001 / Four Seasons Resort at Troon North, Scottsdale, AZ, Honor Award for Design, Colorado Chapter
2001 / Tyson Resource Study, Eureka, MO, Merit Award, Colorado Chapter
2001 / West Broadway Corridor, Council Bluffs, IA, Honor Award, Iowa Chapter
2001 / West Broadway Corridor, Council Bluffs, IA, Merit Award, Colorado Chapter
2000 / Cheyenne Mountain Zoo, Cheyenne, WY, Land Stewardship Award, Colorado Chapter
2000 / Colorado Springs Parks, Recreation + Trails 2000-2010 Master Plan, Colorado Springs, CO, Merit Award, Colorado Chapter
2000 / District of Columbia Business Improvement District, Washington, DC, Merit Award, Potomac + Maryland Chapters
2000 / District of Columbia Downtown Action Plan, Washington, DC, Merit Award, Potomac + Maryland Chapters
2000 / EDAW Summer Student Program, 1980-2000, National Award of Excellence
2000 / Freedom Park, Atlanta, GA, Honor Award, Georgia Chapter
2000 / Gateway Science School Courtyard, St. Louis, MO, National Merit Award
2000 / Gateway Science School Courtyard, St. Louis, MO, President's Award of Excellence, Colorado Chapter
2000 / Georgia Model Urban Forest, Atlanta, GA, Merit Award, Georgia Chapter
2000 / Hershey Children's Garden at Cleveland Botanic Garden, Cleveland, OH, Honor Award, Ohio Chapter
2000 / Hershey Children's Garden, Merit Award, Colorado Chapter
2000 / Lancaster Avenue Redevelopment Website, Fort Worth, TX, Merit Award, Georgia Chapter
2000 / North Shore Riverfront Park, Pittsburgh, PA, Honor Award, Potomac + Maryland Chapters
2000 / Olson Family Garden at St. Louis Children's Hospital, St. Louis, MO, Honor Award, Colorado Chapter
2000 / Omaha Parks System: Restoring the Vision, Omaha, NE, President's Award of Excellence, Colorado Chapter
2000 / PGA's World Golf Village, St. Augustine, FL, Merit Award, Florida Chapter
2000 / St. Louis Downtown Development Action Plan, St. Louis, MO, National Honor Award
2000 / St. Louis Downtown Development Action Plan, St. Louis, MO, Honor Award, Colorado Chapter
2000 / Stapleton Design Book, Denver, CO, Honor Award, Colorado Chapter
2000 / Terrace Gardens at Red Butte Garden + Arboretum, Salt Lake City, UT, Honor Award + Best of Show, Utah Chapter
1999 / Hershey Children's Garden, Cleveland Botanical Garden, Cleveland, OH, Merit Award, Great Plains Chapter
1999 / Terrace Gardens, Red Butte Garden + Arboretum, Salt Lake City, UT, National Design Award
1998 / Disney's Boardwalk Resort, Lake Buena Vista, FL, Award of Excellence, Florida Chapter
1998 / Disney's Celebration Town Center, Celebration, FL, Award of Excellence, Florida Chapter
1998 / Disney's Celebration Town Center, Celebration, FL, Frederick Stesau Honor Award, Florida Chapter
1998 / Gateway to Coastal Georgia: Connecting the Coast, 6 GA Counties, Merit Award, Georgia Chapter
1998 / Kennesaw Mountain National Battlefield Preservation Plan, GA, Merit Award, Georgia Chapter
1998 / Navy Federal Credit Union Expansion, Vienna, VA, Honor Award, Maryland + Potomac Chapter
1998 / Southeastern Parkway and Greenbelt Road, Virginia Beach, VA, Honor Award, Maryland + Potomac Chapter
1998 / Tennyson Center for Children and Families, Denver, CO, Merit Award, Colorado Chapter
1998 / Terrace Gardens at Red Butte Garden + Arboretum, Salt Lake City, UT, Merit Award, Colorado Chapter
1998 / UAPB Campus + Neighborhood Master Plan, Pine Bluff, AR, Honor Award, Georgia Chapter
1998 / Women in Military Service of America Memorial, Washington, DC, Honor Award and Award for Innovative Excellence, Maryland + Potomac Chapter

1997 / Centennial Mall Redevelopment, Lincoln, NE, President's Award for Excellence in Design, Unconstructed Category, Great Plains Chapter

1997 / Centennial Olympic Park, Atlanta, GA, Merit Award, Georgia Chapter

1997 / East Capitol Campus Plaza, Seattle, WA, People's Choice Award, Washington Chapter

1997 / First National Bank Campus, Omaha, NE, Honor Award for Design, Unconstructed Category, Great Plains Chapter

1997 / Texas State Capital Historic South Grounds Restoration, Austin, TX, Merit Award, New Mexico Chapter

1997 / Texas State Capitol Historic South Grounds Restoration, Austin, TX, Merit Award, Texas Chapter

1997 / West Main Street Cultural Arts District, Louisville, KY, Honor Award, Urban Design Category, Potomac/Maryland Chapter

1996 / Coors Field, Denver, CO, Honor Award, Colorado Chapter

1996 / Private Residence, Denver, CO, Honor Award, Design, Colorado Chapter

1996 / Sitka Gateway Development Plan, Sitka, AK, Merit Award for Planning, Colorado Chapter

1996 / Sonnenalp Bavaria Haus, Vail, CO, Honor Award, Colorado Chapter

1995 / Dinosaur Discovery Center, WY, Award of Distinction, Denver Chapter

1995 / Harrison Hospital Roof Garden, Bremerton, WA, Honorable Mention, Washington State Chapter

1995 / Penn State Research Park, State College, PA, Honor Award, Potomac Chapter

1995 / Protection of the Everglades Ecosystem, FL, National Professional Award

1994 / Atlantic Avenue Streetscape, Virginia Beach, VA, Honor Award, Potomac Chapter

1994 / Outstanding Overall Design Firm Award, Colorado Chapter

1994 / Hewlett Packard Ledge Gardens, Fort Collins, CO, Merit Award for Design, Colorado Chapter

1994 / The Peninsula Beverly Hills, Beverly Hills, CA, Merit Award for Design, Colorado Chapter

1994 / "Planning the Green Zone," - 1994 EDAW Summer Student Program Honor Award for Research and Communication and Honor Award for Outstanding Implementation of a Western Land Ethic, Colorado Chapter

1994 / Sallie Mae Offices, Fairfax County, VA, Honor Award, Potomac Chapter

1994 / South Mountain New Community, Draper, UT, Honor Award for Planning, Colorado Chapter

1994 / West Shore/Rash Field Design Competition, Baltimore, MD, Merit Award, Potomac Chapter

1993 / Atlanta Downtown Plan, Atlanta, GA, Merit Award, Georgia Chapter

1993 / Colorado Springs Downtown Plan, Colorado Springs, CO, Merit Award, Colorado Chapter

1993 / Disney's Dixie Landings Resort, Lake Buena Vista, FL, Merit Award, Georgia Chapter

1993 / EDAW Summer Student Program, Atlanta, GA, Merit Award, Georgia Chapter

1993 / Seattle Commons, Seattle, WA, Honor Award, Washington Chapter

1993 / Sutro Historic District, San Francisco, CA, Award of Excellence, CA Council

1992 / AmeriFlora '92, Columbus, OH, Merit Award, Colorado Chapter

1992 / Disney Dixie Landings Resort, Lake Buena Vista, FL, Merit Award, Georgia Chapter

1992 / 1100 Peachtree Street, Atlanta, GA, Merit Award, Georgia Chapter

1991 / Mount Vernon Viewshed Analysis, Alexandria, VA, Merit Award, Georgia Chapter

1990 / Colorado Springs I-25 Corridor Study, Colorado Springs, CO, Merit Award, Colorado Chapter

1990 / Georgia Mountain Resort, Hiwassee, GA, Merit Award, Georgia Chapter

1990 / Jocassee Tie Fold-In Transmission Route, State of SC, Merit Award, Georgia Chapter

1990 / Schaal Residence, Fort Collins, CO, Merit Award, Colorado Chapter

1990 / US Dept of Justice, US Forest Service Reserved Water Rights Case, State of CO, National Honor Award for Communications

1989 / Addenbrooke Park, Lakewood, CO, Honor Award, Colorado Chapter

1989 / Loveland Civic Center, Loveland, CO, Honor Award, Colorado Chapter

1989 / Washington Mutual Tower Plaza, Seattle, WA, Honor Award, Washington Chapter

1988 / Englewood Greenway, Englewood, CO, Honor Award, Colorado Chapter

1988 / Fort Collins Parks + Recreation Master Plan, Fort Collins, CO, Honor Award, Colorado Chapter

1988 / Little Dry Creek Flood Control Improvements, Englewood, CO, Honor Award, Colorado Chapter

1987 / Fort Collins Xeriscape Demonstration Garden, Fort Collins, CO, Merit Award, Colorado Chapter

1987 / Grand Canyon National Park Landscape Program, State of AZ, Merit Award, Colorado Chapter

1987 / Melvin Drive Park, Atlanta, GA, Merit Award, Georgia Chapter

1987 / Mission Bay Plan, San Francisco, CA, National Merit Award

1987 / Mission Bay Plan, San Francisco, CA, Merit Award, California Council

1987 / University of Virginia Central Grounds Study, Charlottesville, VA, National Honor Award

1985 / Grand Junction Transmission Line Study, State of CO, Merit Award, Colorado Chapter

1985 / Guadalupe River Park Master Plan, San Jose, CA, National Honor Award

1985 / Guadalupe River Park Master Plan, San Jose, CA, Merit Award, Northern California Chapter

1985 / Morrison Demonstration Garden at Denver Botanic Gardens, CO, President's Award, Colorado Chapter

1984 / Broadway Streetscape, Columbus, GA, Merit Award, Georgia Chapter

1984 / I-25 Corridor Study, Pueblo, CO, President's Award, Colorado Chapter

1984 / Signer's Memorial, Washington, DC, National Honor Award

1983 / Denver Botanic Gardens--Alpine and Rock Garden, Denver, CO, National Merit Award

1983 / Fort Collins Downtown, Fort Collins, CO, Merit Award, Colorado Chapter

1983 / Puu Alii Residential Development, Oahu, HI, Merit Award, Hawaii Chapter

1983 / Riley Ridge Visual Resource Assessment, CO, Merit Award, Colorado Chapter

1983 / Rocky Mountain Energy Company Headquarters, CO, National Merit Award

1983 / "Siting of Major Facilities", published by McGraw-Hill, Honor Award, Northern California Chapter

1982 / Denver Botanic Gardens - Alpine and Rock Garden, Denver, CO, Merit Award, Colorado Chapter

1982 / Fairfax Center Area Comprehensive Plan, Fairfax County, VA, National Merit Award

1981 / Colorado Recreational Trails Program, State of CO, Merit Award for Non-Motorized Plan

1981 / Hewlett-Packard Company, Fort Collins, CO, National Merit Award

1981 / Papal Mass on the Mall, Washington, DC, Honor Award, Virginia Chapter

1980 / Federal National Mortgage Association, Washington, DC, Honor Award, Maryland Chapter

1980 / West Channel/Cabrillo Beach Recreational Complex, CA, National Merit Award

1979 / "Creating Land for Tomorrow," ASLA Manual, National Honor Award

1979 / Hells Canyon Visual Resource Inventory, State of California, National Merit Awards

1979 / National Capitol Visual Resource Inventory, Washington, DC, National Honor Award

1979 / Nisqually Nat'l Wildlife Refuge, Olympia, WA, National Honor Award

1979 / Visual Sensitivity of River Recreation to Power Plants, State of MN, National Merit Award

1978 / Tucson Community Center, Tucson, AZ, National Honor Award

1978 / Wailea Town Center, Maui, HI, Honor Award, Hawaii Chapter

1977 / Lihue Development Plan, State of Hawaii, National Merit Award

1975 / Bank of Hawaii Service Center, State of California, Honor Award, Hawaii Chapter

1975 / Davis Pacific Center, Honolulu, HI, Honor Award, Hawaii Chapter

1975 / Honolulu International Airport, Honolulu, HI, Honor Award, Hawaii Chapter

1975 / Iman Reza Shrine, Mashad, Iran, Merit Award, Hawaii Chapter

1975 / Kualoa Regional Park, Oahu, HI, Honor Award, Hawaii Chapter

1975 / San Francisco Bay National Wildlife Refuge Master Plan, CA, National Merit Award

1974 / Alberta-California Pipeline Environmental Impact Statement, National Merit Award

1974 / Chinese Playground, San Francisco, CA, National Merit Award

1974 / Duluth Freeway Routing, Duluth, MN, National Merit Award

1974 / Olympia-Soda Springs Transmission Line EIS, State of Washington, National Merit Award

1974 / Tucson Community Center, Tucson, AZ, National Honor Award

1973 / Kauai General Plan, Development Plan and Ordinances, Kauai, HI, National Honor Award

1973 / Minneapolis Parkways, Minneapolis, MN, National Merit Award

1973 / Wailuku-Kahului General Plan, HI, National Merit Award

1972 / PG&E Davenport, CA, National Merit Award

1972 / Santa Ana River Study, CA, National Merit Award

1972 / Sioux City Central Business District Plan, Sioux City, IA, Award for Design Excellence

1971 / Wailua River State Park, State of Hawaii, National Merit Award

1970 / Lodi Park, New Delhi, India, National Merit Award

1970 / Mississippi River Waterfront, State of MN, National Merit Award

1970 / State of Hawaii Land Use Review, National Merit Award

EDAW / Excellence

Awards beyond ASLA. In addition to a long list of awards in both ASLA national and chapter programs, EDAW has been the recipient of hundreds of awards bestowed by other professional societies, such as the American Institute of Architects (AIA), American Planning Association (APA), the Urban Land Institute (ULI) and governing bodies of the landscape architecture and planning professions in other countries. Recent highlights include:

- 2009 / Kigali Master Plan, Rwanda (A)
Daniel Burnham Award, American Planning Association
- 2008 / Flatbush Avenue Streetscape Improvements, New York, NY (B)
Award for Excellence in Design, New York City Arts Commission
- 2008 / Midross with Loch Lomond and Trossachs National Park, Scotland
Winner, Scottish Awards for Quality in Planning
- 2008 / Murrays Beach at Wallarah Peninsula, New South Wales, Australia (C)
National Award for Design, Australian Institute of Landscape Architects
- 2008 / Shenzhen Coastal Park System (D)
Silver Award, Planning, Hong Kong Institute of Landscape Architects
- 2008 / Tokyo Midtown, Tokyo (E)
Global Award for Excellence, Urban Land Institute
Award for Excellence (Asia), Urban Land Institute
Honor Award, American Institute of Architects, California Chapter
- 2007 / The Fifth Garden, Shenzhen, China (F)
Silver Award, Design, Hong Kong Institute of Landscape Architects
- 2007 / Sheaf Square, Sheffield, UK
Winner, Design, National Awards, The Landscape Institute
Winner, Local Landscape Planning, National Awards, The Landscape Institute
Winner, the President's Award, National Awards, The Landscape Institute
- 2006 / Ladera Ranch, Orange County, CA, Award for Excellence, Urban Land Institute
- 2006 / Qiaonan Village Historical Preservation, China
Architectural Record - BusinessWeek Good Design is Good Business Awards
- 2006 / Stapleton Redevelopment, Denver, CO,
Award for Excellence, Urban Land Institute
- 2006 / Li Lake Parklands, Wuxi, China (G)
Award for Excellence (Asia), Urban Land Institute
Honor Award, Excellence in Waterfront, the Waterfront Center
- 2005 / Lower Lea Valley Regeneration, Olympic Games & Legacy, London, UK
Special Award for National Planning, Royal Town Planning Institute
- 2005 / National Capital Urban Design & Security Plan, Washington, DC
Award of Excellence, Smart Growth, American Planning Association
- 2004 / Melbourne Docklands, Melbourne, Australia (H)
Australia Award for Urban Design Excellence, Royal Australian Institute of Architects, Australian Institute of Landscape Architecture and Planning Institute of Australia
- 2004 / Parc Diagonal Mar, Barcelona, Spain (I)
Award for Excellence (Europe), Urban Land Institute
- 2004 / Royal Victoria Square, London, UK, Design Award, The Landscape Institute (UK)
- 2003 / Jinji Lake, Suzhou, China, Top Honor Award, the Waterfront Center
- 2002 / Consultancy of the Year, Royal Town Planning Institute
- 2001 / Sustainable Planning Report, US Department of Defense Tri-Services
National Planning Award, American Planning Association
- 1998 / Gateway to Coastal Georgia: Connecting the Coast and 6 Georgia Counties
National Honor Award, Planning Document, American Planning Association
- 1997 / Fort Ord Reuse Plan and EIR, Monterey, CA
National Honor Award, American Planning Association



Through its intern program and strong connections with the academy, EDAW has played a vital role in shaping the way many learn about land design.

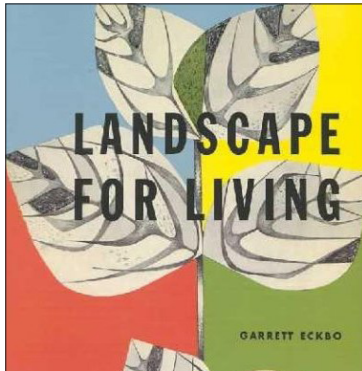

As an idea-driven firm, EDAW has long had a strong belief in giving back to the profession of landscape architecture and in the development and maturation of the field. Since 1980, EDAW's intern program has been its premiere public initiative. It has brought students from all over the world to work in real-world design and planning project sessions. This highly acclaimed (and highly competitive) program was honored with a Landscape Architecture Award of Excellence from the ASLA in 2000.

The program challenges the best international interns with a workshop in a select destination on a progressive project, offering an extraordinary opportunity for students to get real experience while working alongside EDAW practitioners. After a two-week intense workshop, the interns then disperse to all corners of the world to work in an EDAW studio for three months. Previous intern programs have been in the Middle East, China, the UK, Australia, and across the United States. Today, hundreds of designers have graduated from EDAW's program. This year, in a spirit of innovation, the program will be refreshed as a virtual worldwide open ideas competition.

EDAW's involvement with education does not stop with its interns. Lecturing and academic participation are a critical component of principal-ship at the firm. In places like China, where landscape architecture barely existed as a profession 15 years ago, EDAW's impact on an entire generation of landscape architects has been felt through programs such as an annual design boot camp for young designers, and a yearly sustainable design forum in partnership with Tsinghua University in Beijing.

Clockwise from top left: EDAW Summer Student Programs in Los Angeles (1997), Beijing (2003), Colorado (1980), Nassau, the Bahamas (2004), and Petra, Jordan (1998).

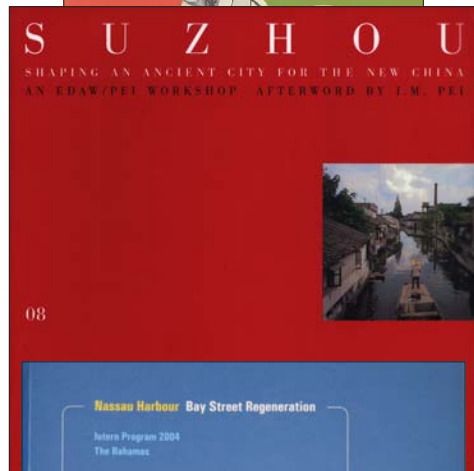

08

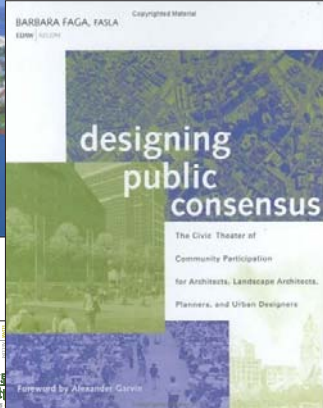
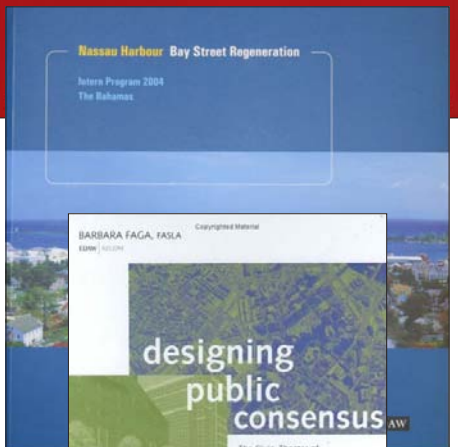

Left: EDAW and its practitioners have authored numerous books on topics related to landscape architecture. A selection (from top to bottom) includes Garrett Eckbo's *Landscapes for Living*, EDAW and Pei's *Suzhou: Shaping and Ancient City for the New China*, the book produced from the Nassau Intern Program, Barbara Faga's *Designing Public Consensus*, The Chinese-language *Wetland Restoration Handbook* and the forthcoming EDAW Monograph.

EDAW / Ecology

A guiding strand throughout EDAW's history has been a deep commitment to the land, which is best reflected in innovative work that has advanced the sustainable agenda worldwide in concrete ways.

"Today, in both the public and private sector, the need for responsible environmental planning and design is greater than at any time in history," opens EDAW's firm brochure from the late 1960s. This sense of urgency has driven EDAW since those days, and it can be seen in project work that has consistently been ahead of its time, whether in 1969 or 2009. At EDAW, we often say that process is just as important as product. The result has been not just a consistent delivery of sustainably-minded projects, but valuable tools and discoveries. Landscape architecture is the combined expression of ecology, art and planning – and as EDAW has so consistently pushed – increasingly science and advocacy. It is the future of the profession.

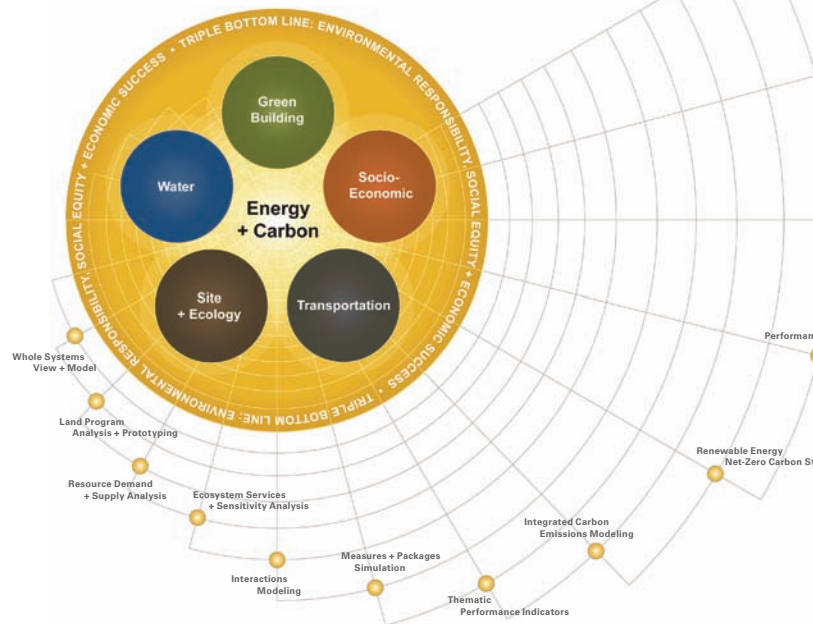

Sustainable Systems Integration Model (SSIM). Developed in the last two years internally by EDAW, SSIM is a patented tool that goes beyond land planning as usual to inform the most appropriate and carbon neutral development program.



Stapleton, Denver. The largest infill project in the United States.



Shanghai Chemical Industrial Park. A petrochemical dumping ground transformed into a natural wastewater treatment ecosystem that doubles as a public park.



South Bay Salt Ponds Restoration, California. The largest wetland restoration on the US West Coast.

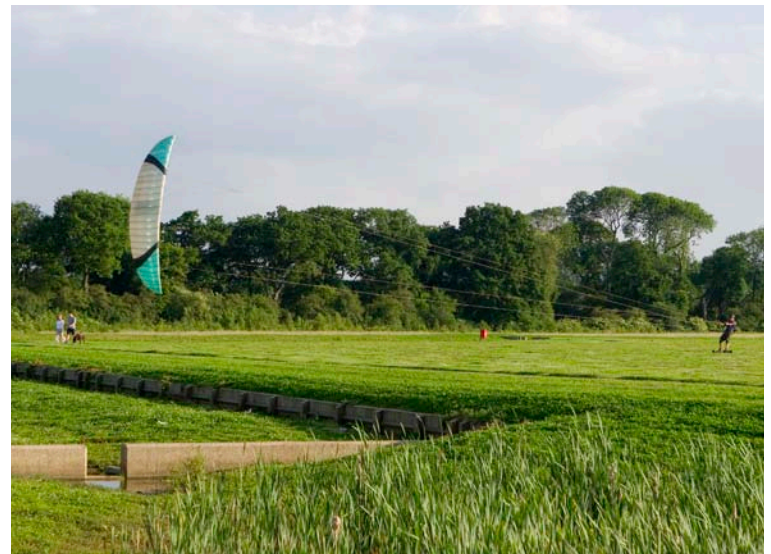

Upton, UK. A "practical way of creating a sustainable community that is inclusive and forward-thinking."

EDAW / Multidisciplinary culture

The fusion of disciplines and ideas is central to the EDAW ethos. Here, landscape architecture leads a deeply integrated team that brings together urban design, ecology, economics, and strategic planning.

It is the only practice of its kind in the world.

EDAW's origins and roots are in landscape architecture. From these antecedents has grown a practice that encompasses environmental planning and design, urban design and planning, and strategic planning and land economics. At EDAW, we like to say the ideal project is one that integrates all.



Planning and urban design. EDAW has a long record in the field of regional planning exemplified by a project such as the St. Joe Million Acre master plan (above) that brought together landscape architects, planners, economists and information technology specialists to work on a market-based vision for development that is regional placemaking on an area of one million acres across 14 counties.



Economic Development & Strategic Planning. The thinking behind EDAW's urban regeneration strategies integrates factors such as economics and place-branding as critical components to a design exercise. The result is plans that are both socially sustainable, but also feasible and implementable. It may sound like an innovative approach – fusing economy and social development with land design – but EDAW has long done it this way with projects such as the New Orleans Ninth Ward Community Development Study (left), winner of an APA award in 1981.

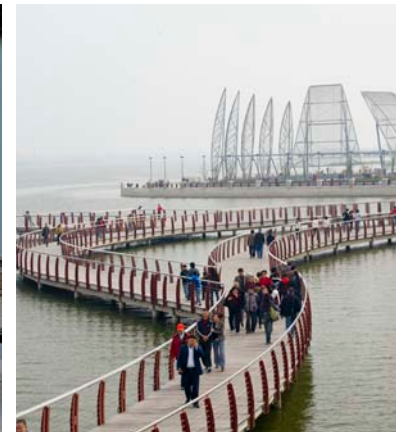

Ecology and design from Barcelona to Bengbu. At EDAW, landscape architects often play the role of ecological designers. In waterfront parks such as Parc Diagonal Mar in Barcelona (left, 2005 ASLA national honor award) and Dragon Lake Bridge Park in Bengbu, China (above, completed 2008), EDAW's ability to reintroduce clean water was a critical component of the design.

Saadiyat Island, Abu Dhabi, integrating multiple disciplines. EDAW's ongoing work here exemplifies the firm's multidisciplinary approach on an existing island that will be a 150,000-person extension to the city. As lead consultant, EDAW provides a variety of roles – landscape architect for the shared public realm, urban designer and master planner, economic planner and ecological designer. With EDAW at the helm, this monumental development puts the land front and center, with high density neighborhoods, renewable energy and restored mangroves. Central to the project is a signature cultural district with new branches of the Guggenheim and Louvre (designed by Frank Gehry and Jean Nouvel) and a performing arts center by Zaha Hadid and a Maritime Museum by Tadao Ando.

EDAW / International outlook

EDAW's outlook has always been cosmopolitan. The firm has long practiced around the world in a real and meaningful way, and today is the most internationalized landscape architecture practice.

Origins.

Early design work from the 1960s such as a park in Kasatsu, Japan (right) and ASLA National Award winner Lodi Park in the heart of Lutyens' New Delhi (far right), foretold a distinctly exotic streak that remains a hallmark of EDAW's portfolio. With roots in California that then spread to points across the United States and then the world. The inevitable outcrop of a broad-minded philosophy and worldly outlook that characterizes the firm's leadership, today EDAW is the most global landscape architecture practice – half of the firm's staff resides overseas. Recently the firm has been making forays in the Developing World, from Rwanda to Pakistan.

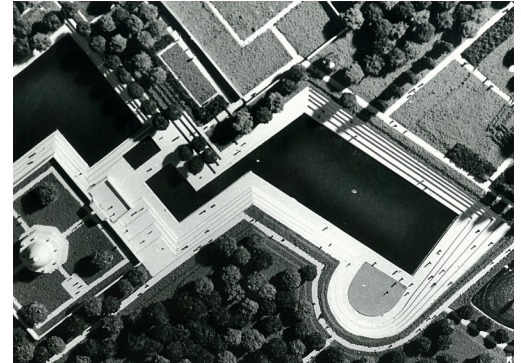

United Kingdom

/ Studios in London, Edinburgh and Manchester

/ EDAW won 3 Royal Town Planning Institute (RTPI) awards in 2008

/ Right: Royal Victoria Square, London
/ Far right: Sheaf Square, Sheffield

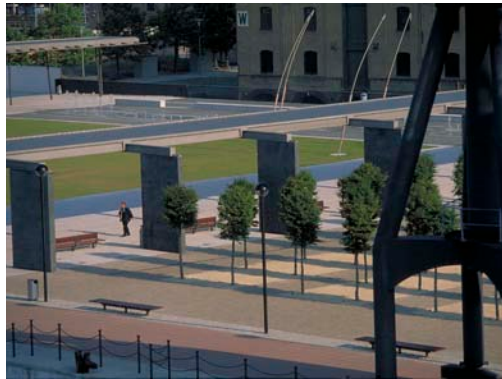

Asia

/ Studios in Hong Kong, Shanghai, Beijing, Singapore and Guangzhou

/ EDAW won an unprecedented 8 Hong Kong Institute of Landscape Architects (HKILA) awards in 2008

/ Right: Dragon Lake Park, Bengbu
/ Far right: Yingze Streetscape, Taiyuan



Australia

/ Studios in Brisbane, Sydney and Melbourne

/ EDAW won an unprecedented 5 Australian Institute of Landscape Architects (AILA) awards in 2008

/ Right: Roma Street Parklands, Brisbane
/ Far right: Ipswich River Heart Park

